

Catalog Shakers



SensiHome
Consider it *done!*



Content

- Our Story
- Cabinet Constroction
- Door Styles
- Base Cabinets
- Vanity Cabinets
- Wall Cabinets
- Pantry Cabinets
- Accesories
- Terms & Conditions

Our Story

SensiHome was founded on the conviction that affordable prices, quality products, and dedicated customer service should be the defining characteristics of your cabinet manufacturer. This conviction drives every part of our business.

We measure our success by our ability to ensure your project is completed on time, on spec, and on budget. Our products are priced competitively across all categories. We select only **high-quality materials** and **regularly perform** quality checks to ensure we are always delivering a product you can be proud of. Our online channels allow you to interact with us on your time, all through our user-friendly platform.

SensiHome is a partner you can rely on. Whatever you need, *Consider it Done!*



White Shaker Cabinet Construction

Our cabinet doors are created with the highest quality Birch - a strong and durable hardwood whose beautiful features make it a perfect wood type for modern furniture.

Our cabinet carcasses are constructed with all-birch plywood with wood veneer. No formaldehyde is added during our plywood manufacturing process. Our sides, bottoms, and shelves are 3/4" plywood, reinforced through a 3/4" plywood hanging rail.

Our drawer boxes are held together through dovetail joint construction and all drawers come with under-mounted, full-extension, soft-closing slides.

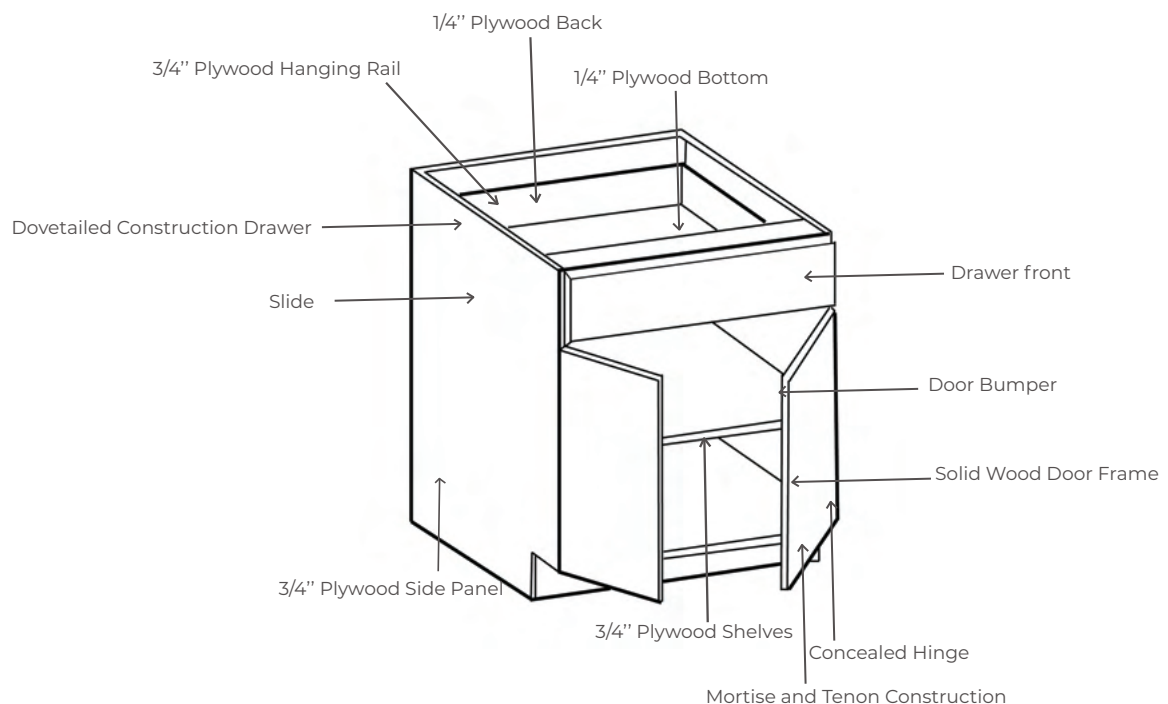

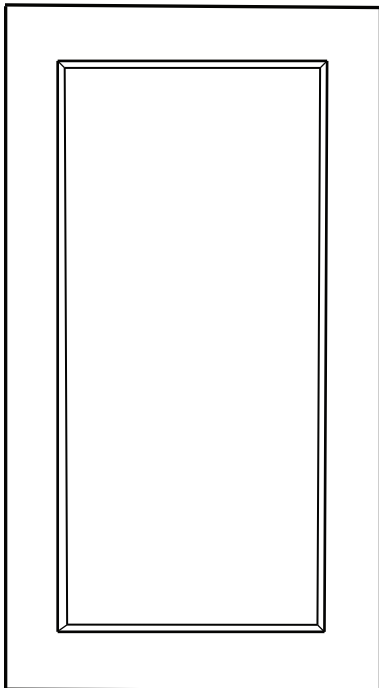

White Single Shaker

Specifications:

- Birch Wood Species
- 3/4" Mortise and Tenon Construction
- Doors: 3" Stiles and Rails
- Drawer Fronts: 3" Stiles and 2 1/2" Rails
- Beveled Interior Edge
- White Interior and Exterior Finish
- Matching Finish on Sides and Edge Banding

Cosmos (CS)

White Double Shaker

Specifications:

- Birch Wood Species
- 3/4" Mortise and Tenon Construction
- Doors: 3" Stiles and Rails
- Drawer Fronts: 3" Stiles and 2 1/2" Rails
- Beveled interior Edge
- White Interior and Exterior Finish
- Matching Finish on Sides and Edge Banding

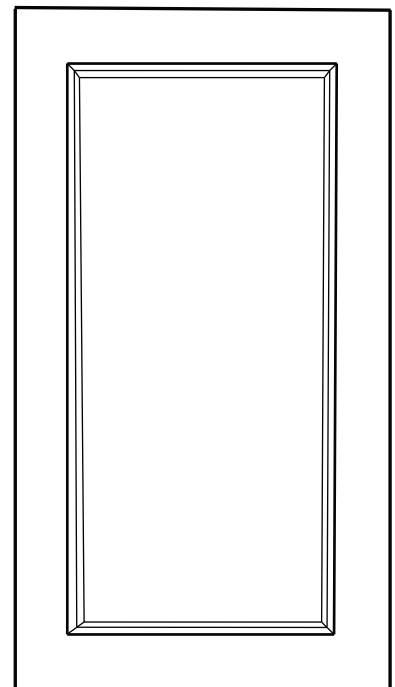

Camellia (CA)

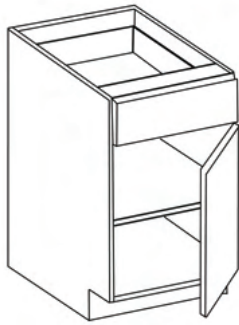

Base Single Door

SKU	Width	Height	Depth	CS Price	CA Price
B06FH	6"	34 1/2"	23 3/4"	\$389.72	\$399.46
B09	9"	34 1/2"	23 3/4"	\$518.75	\$531.72
B12	12"	34 1/2"	23 3/4"	\$553.87	\$567.72
B15	15"	34 1/2"	23 3/4"	\$597.86	\$612.81
B18	18"	34 1/2"	23 3/4"	\$652.92	\$669.24
B21	21"	34 1/2"	23 3/4"	\$697.31	\$714.74

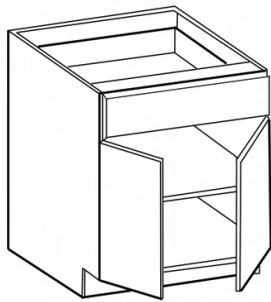

Base Double Door

SKU	Width	Height	Depth	CS Price	CA Price
B24	24"	34 1/2"	23 3/4"	\$776.07	\$795.47
B27	27"	34 1/2"	23 3/4"	\$828.36	\$849.07
B30	30"	34 1/2"	23 3/4"	\$874.36	\$896.22
B33	33"	34 1/2"	23 3/4"	\$972.49	\$996.80
B36	36"	34 1/2"	23 3/4"	\$1,016.57	\$1,041.98

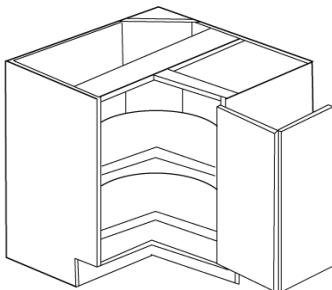

Lazy Susan Base

SKU	Width	Height	Depth	CS Price	CA Price
BLS33	33"	34 1/2"	23 3/4"	\$1,177.13	\$1,206.56
BLS36	36"	34 1/2"	23 3/4"	\$1,268.71	\$1,300.43

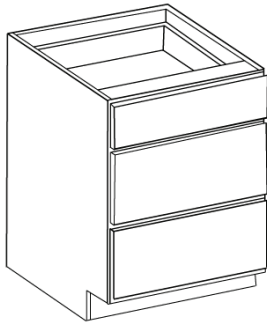

Drawer Base

SKU	Width	Height	Depth	CS Price	CA Price
3DB12	12"	34 1/2"	23 3/4"	\$890.63	\$912.90
3DB15	15"	34 1/2"	23 3/4"	\$946.33	\$969.99
3DB18	18"	34 1/2"	23 3/4"	\$1003.05	\$1028.13
3DB21	21"	34 1/2"	23 3/4"	\$1,080.98	\$1,108.00
3DB24	24"	34 1/2"	23 3/4"	\$1,158.39	\$1,187.35
3DB27	27"	34 1/2"	23 3/4"	\$1,253.80	\$1,285.15
3DB30	30"	34 1/2"	23 3/4"	\$1,349.38	\$1,383.11
3DB33	33"	34 1/2"	23 3/4"	\$1,423.66	\$1,459.25
3DB36	36"	34 1/2"	23 3/4"	\$1,519.24	\$1,557.22

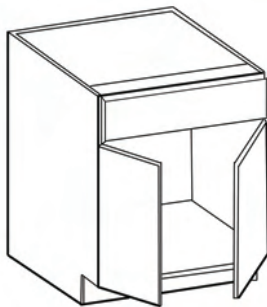

Sink Base

SKU	Width	Height	Depth	CS Price	CA Price
SB30	30"	34 1/2"	23 3/4"	\$684.50	\$701.61
SB33	33"	34 1/2"	23 3/4"	\$720.80	\$738.82
SB36	36"	34 1/2"	23 3/4"	\$758.60	\$777.57

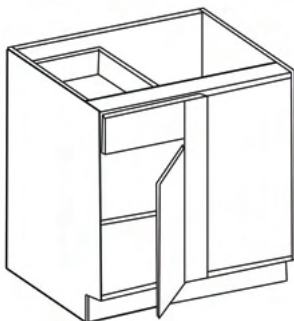

Base Blind Corner

SKU	Width	Height	Depth	CS Price	CA Price
BBC39	39"	34 1/2"	23 3/4"	\$931.70	\$954.99
BBC42	42"	34 1/2"	23 3/4"	\$998.44	\$1023.40
BBC45	45"	34 1/2"	23 3/4"	\$1,047.76	\$1,073.95

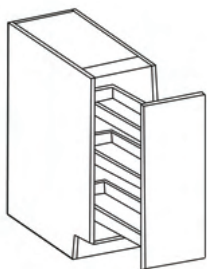

Base Spice Rack

SKU	Width	Height	Depth	CS Price	CA Price
BSR09	9"	34 1/2"	23 3/4"	\$709.72	\$727.46

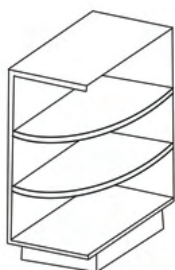

Base Open Shelf

SKU	Width	Height	Depth	CS Price	CA Price
BOES09	9"	34 1/2"	23 3/4"	\$357.78	N/A



Base Wine Rack

SKU	Width	Height	Depth	Price	CA Price
BWR06	6"	34 1/2"	23 3/4"	\$324.56	N/A

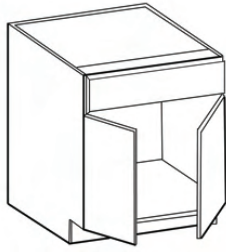

Vanity Sink Base Double Door

SKU	Width	Height	Depth	CS Price	CA Price
VSDB24	24"	34 1/2"	21"	\$637.62	\$653.56
VSDB30	30"	34 1/2"	21"	\$732.23	\$750.54
VSDB36	36"	34 1/2"	21"	\$819.06	\$839.54

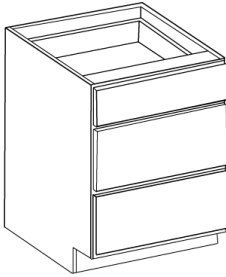

Vanity 3 Drawers Base (12" - 18")

SKU	Width	Height	Depth	CS Price	CA Price
3VDB12	12"	34 1/2"	21"	\$995.18	\$1,020.06
3VDB15	15"	34 1/2"	21"	\$1,062.05	\$1,088.60
3VDB18	18"	34 1/2"	21"	\$1,124.67	\$1,152.79

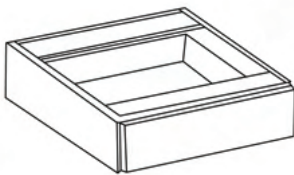

Vanity Knee Drawer

SKU	Width	Height	Depth	CS Price	CA Price
VKD30	30"	6"	21"	\$492.47	\$504.78

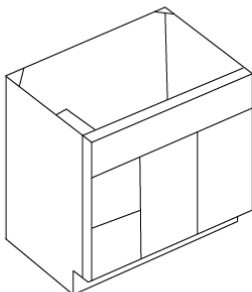

Vanity Sink Drawer Base

SKU	Width	Height	Depth	CS Price	CA Price
VSD30L	30"	34 1/2"	21"	\$1,178.85	\$1,208.32
VSD30R	30"	34 1/2"	21"	\$1,178.85	\$1,208.32
VSD36L	36"	34 1/2"	21"	\$1,368.03	\$1,402.23
VSD36R	36"	34 1/2"	21"	\$1,368.03	\$1,402.23

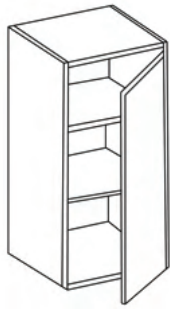

Wall Single Door 30"

SKU	Width	Height	Depth	CS Price	CA Price
W0930	9"	30"	12"	\$340.07	\$348.57
W1230	12"	30"	12"	\$371.58	\$380.87
W1530	15"	30"	12"	\$441.30	\$452.33
W1830	18"	30"	12"	\$493.01	\$505.34
W2130	21"	30"	12"	\$544.58	\$558.19

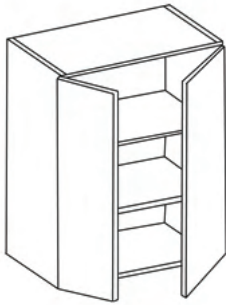

Wall Double Door 30"

SKU	Width	Height	Depth	CS Price	CA Price
W2430	24"	30"	12"	\$653.13	\$669.46
W2730	27"	30"	12"	\$704.68	\$722.30
W3030	30"	30"	12"	\$756.38	\$775.29
W3330	33"	30"	12"	\$807.94	\$828.14
W3630	36"	30"	12"	\$859.50	\$880.99

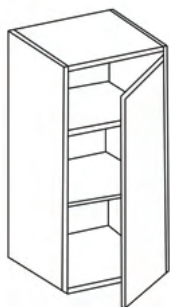

Wall Single Door 36"

SKU	Width	Height	Depth	CS Price	CS Price
W0936	9"	36"	12"	\$390.14	\$399.89
W1236	12"	36"	12"	\$458.72	\$470.19
W1536	15"	36"	12"	\$526.90	\$540.07
W1836	18"	36"	12"	\$586.07	\$600.72
W2136	21"	36"	12"	\$645.08	\$661.21

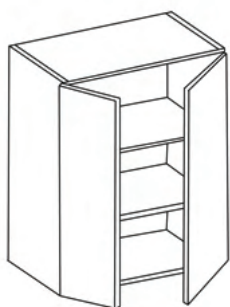

Wall Double Door 36"

SKU	Width	Height	Depth	CS Price	CA Price
W2436	24"	36"	12"	\$740.16	\$758.66
W2736	27"	36"	12"	\$796.16	\$816.06
W3036	30"	36"	12"	\$852.46	\$873.77
W3336	33"	36"	12"	\$908.90	\$931.62
W3636	36"	36"	12"	\$964.90	\$989.02

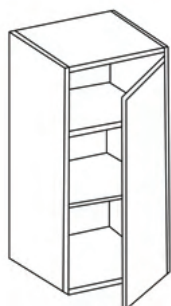

Wall Single Door 42"

SKU	Width	Height	Depth	CS Price	CA Price
W0942	9"	42"	12"	\$456.10	\$467.50
W1242	12"	42"	12"	\$520.43	\$533.44
W1542	15"	42"	12"	\$597.77	\$612.71
W1842	18"	42"	12"	\$664.86	\$681.48
W2142	21"	42"	12"	\$739.12	\$757.60

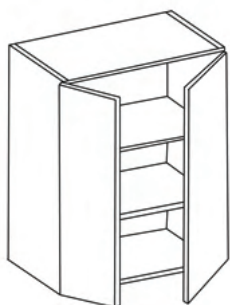

Wall Double Door 42"

SKU	Width	Height	Depth	CS Price	CA Price
W2442	24"	42"	12"	\$907.49	\$930.18
W2742	27"	42"	12"	\$976.59	\$1,001.0
W3042	30"	42"	12"	\$1,045.69	\$1,071.83
W3342	33"	42"	12"	\$1,115.25	\$1,143.13
W3642	36"	42"	12"	\$1,184.19	\$1,213.79

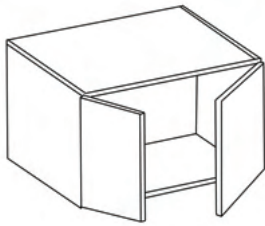

Wall Double Door 12"

SKU	Width	Height	Depth	CS Price	CA Price
W3012	30"	12"	12"	\$385.04	\$394.67
W3312	33"	12"	12"	\$426.83	\$437.50
W3612	36"	12"	12"	\$468.62	\$480.34
W3612-24	36"	12"	23 3/4"	\$650.40	\$666.66

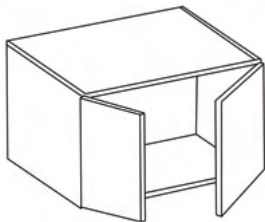

Wall Double Door 15"

SKU	Width	Height	Depth	CS Price	CA Price
W3015	30"	15"	12"	\$432.98	\$443.80
W3315	33"	15"	12"	\$469.60	\$481.34

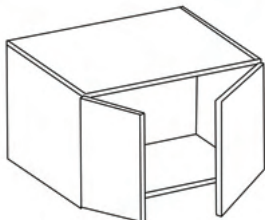

Wall Double Door 18"

SKU	Width	Height	Depth	CS Price	CA Price
W3018	30"	18"	12"	\$487.84	\$500.04
W3318	33"	18"	12"	\$520.22	\$533.23
W3618	36"	18"	12"	\$552.61	\$566.43
W3618-24	36"	18"	23 3/4"	\$761.55	\$780.59

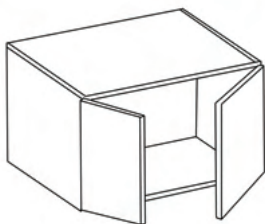

Wall Double Door 21"

SKU	Width	Height	Depth	CS Price	CA Price
W3021	30"	21"	12"	\$539.97	\$553.47

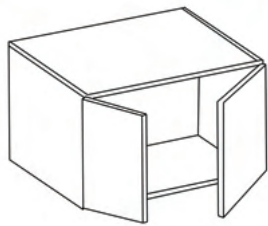

Wall Double Door 24"

SKU	Width	Height	Depth	CS Price	CA Price
W3024	30"	24"	12"	\$677.69	\$694.63
W3624	36"	24"	12"	\$774.88	\$794.25
W3624-24	36"	24"	23 3/4"	\$986.15	\$1,010.80

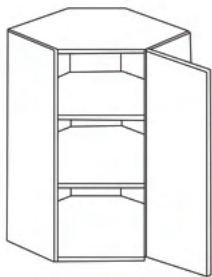

Wall Diagonal Corner

SKU	Width	Height	Depth	CS Price	CA Price
WDC2430	24"	30"	12"	\$769.25	\$788.48
WDC2436	24"	36"	12"	\$842.24	\$863.30
WDC2442	24"	42"	12"	\$1,059.11	\$1,085.59

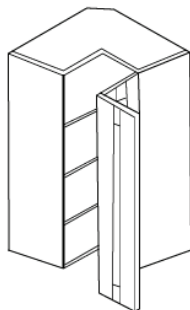

Wall Easy Reach

SKU	Width	Height	Depth	CS Price	CA Price
WER2430	24"	30"	12"	\$904.52	\$927.13
WER2436	24"	36"	12"	\$1,003.29	\$1,028.37
WER2442	24"	42"	12"	\$1,156.63	\$1,185.55

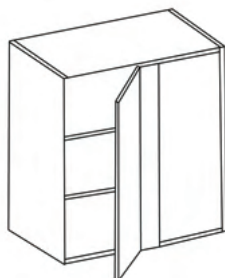

Wall Blind Corner 30"

SKU	Width	Height	Depth	CS Price	CA Price
WBC2730	27"	30"	12"	\$696.21	\$713.62
WBC3330	33"	30"	12"	\$727.49	\$745.68

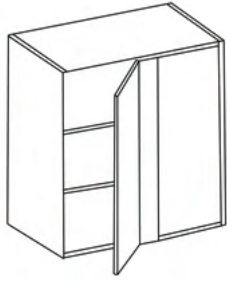

Wall Blind Corner 36"

SKU	Width	Height	Depth	CS Price	CA Price
WBC2736	27"	36"	12"	\$801.19	\$821.22
WBC3336	33"	36"	12"	\$812.39	\$832.70

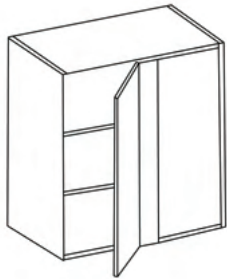

Wall Blind Corner 42"

SKU	Width	Height	Depth	CS Price	CA Price
WBC2742	27"	42"	12"	\$864.24	\$885.85
WBC3342	33"	42"	12"	\$1,002.60	\$1,027.67

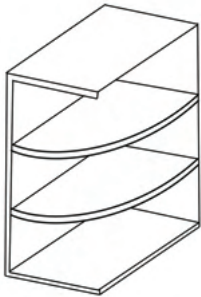

Wall Open End Shelf 36"

SKU	Width	Height	Depth	CS Price	CA Price
WOES0936	9"	36"	12"	\$320.33	N/A

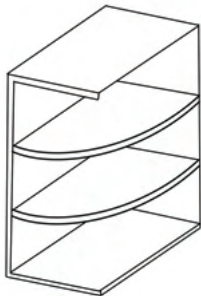

Wall Open End Shelf 42"

SKU	Width	Height	Depth	CS Price	CA Price
WOES1242	12"	42"	12"	\$396.65	N/A

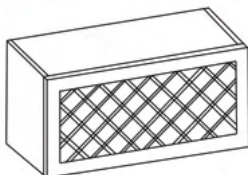

Wine Rack Cabinet

SKU	Width	Height	Depth	CS Price	CA Price
WR3612	36"	12"	12"	\$503.90	N/A
WR3615	36"	15"	12"	\$607.10	N/A



Pantry Cabinet 84"

SKU	Width	Height	Depth	CS Price	CA Price
PC1884	18"	84"	23 3/4"	\$1,745.10	\$1,788.73
PC2484	24"	84"	23 3/4"	\$1,951.28	\$2,000.06
PC3084	30"	84"	23 3/4"	\$2,221.60	\$2,277.14

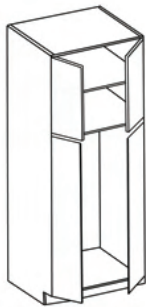

Pantry Cabinet 90"

SKU	Width	Height	Depth	CS Price	CA Price
PC1890	18"	90"	23 3/4"	\$1,828.70	\$1,874.42
PC2490	24"	90"	23 3/4"	\$2,039.87	\$2,090.87
PC3090	30"	90"	23 3/4"	\$2,318.49	\$2,376.45

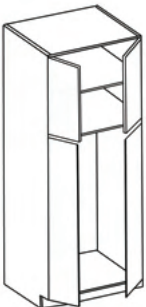

Pantry Cabinet 96"

SKU	Width	Height	Depth	CS Price	CA Price
PC1896	18"	96"	23 3/4"	\$1,931.02	\$1,979.30
PC2496	24"	96"	23 3/4"	\$2,153.73	\$2,207.57
PC3096	30"	96"	23 3/4"	\$2,429.85	\$2,490.60

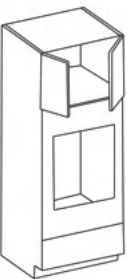

Pantry Double Oven 30"

SKU	Width	Height	Depth	CS Price	CA Price
DOC3084	30"	84"	23 3/4"	\$2,627.21	\$2,692.89
DOC3090	30"	90"	23 3/4"	\$2,719.71	\$2,787.70
DOC3096	30"	96"	23 3/4"	\$2,823.14	\$2,893.72



Glass Door Wall Diagonal Corner

SKU	Width	Height	Depth	CS Price	CA Price
GDWDC243012	16"	29 7/8"	3/4"	\$286.22	\$293.38
GDWDC243612	16"	35 7/8"	3/4"	\$343.38	\$351.96
GDWDC244212	16"	41 7/8"	3/4"	\$400.82	\$410.84

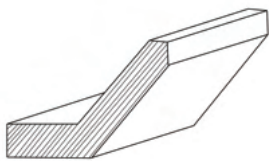

White Angle Crown Molding

SKU	Width	Height	Depth	CS Price	CA Price
ACM	96"	3 3/4"	1/2"	\$284.82	N/A

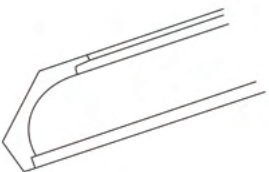

White Classic Cove Molding

SKU	Width	Height	Depth	CS Price	CA Price
CVCM	96"	3 3/4"	3/4"	\$200.37	N/A

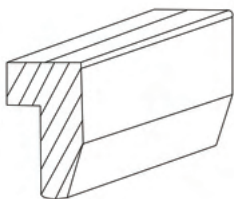

White Light Molding Shaker

SKU	Width	Height	Depth	CS Price	CA Price
LMS	96"	2"	3/4"	\$188.80	N/A

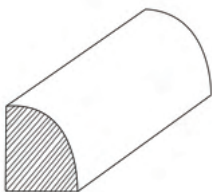

White Outside Corner Molding

SKU	Width	Height	Depth	CS Price	CA Price
OCM8	96"	3/4"	3/4"	\$61.35	N/A

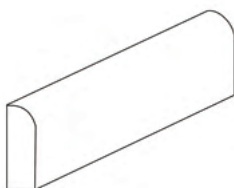

White Scribe Molding

SKU	Width	Height	Depth	CS Price	CA Price
SM8	96"	3/4"	1/4"	\$49.72	N/A

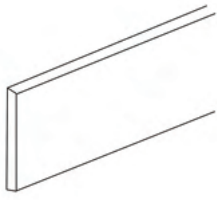

White Toe Kick

SKU	Widht	Height	Depth	Price	CA Price
TK8	96"	4 1/2"	3/4"	\$73.26	N/A



White Finish Back Panel

SKU	Widht	Height	Depth	CS Price	CA Price
PNL4896	48"	96"	1/4"	\$412.35	N/A



Pantry Decorative Panel

SKU	Widht	Height	Depth	CS Price	CA Price
UCDP90	24 1/2"	85 1/2"	3/4"	\$1,001.35	\$1,026.38
UCDP96	24 1/2"	91 1/2"	3/4"	\$1,067.94	\$1,094.64



Wall Decorative Panel

SKU	Widht	Height	Depth	CS Price	CA Price
MWEP1230	12 3/4"	30"	3/4"	\$194.62	\$199.49
MWEP1236	12 3/4"	36"	3/4"	\$233.32	\$239.15
MWEP1242	12 3/4"	42"	3/4"	\$274.95	\$281.82

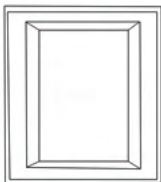

Base Decorative Panel

SKU	Widht	Height	Depth	Price	CA Price
MWEP2430	24 1/2"	30"	3/4"	\$403.38	\$413.46



White Refrigerator End Panel

SKU	Widht	Height	Depth	CS Price	CA Price
REP3696	36 1/2"	96"	3/4"	\$585.57	N/A

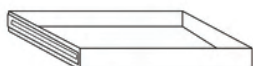

Pull Out Tray

SKU	Widht	Height	Depth	CS Price	CA Price
ROT18	18"	3"	20"	\$270.29	N/A
ROT24	24"	3"	20"	\$289.57	N/A
ROT30	30"	3"	20"	\$309.00	N/A
ROT36	36"	3"	20"	\$317.24	N/A



Filler 3"

SKU	Widht	Height	Depth	CS Price	CA Price
F336	3"	36"	3/4"	\$51.34	N/A
F342	3"	42"	3/4"	\$57.08	N/A
F396	3"	96"	3/4"	\$191.09	N/A



Filler 6"

SKU	Widht	Height	Depth	CS Price	CA Price
F636	6"	36"	3/4"	\$107.82	N/A
F642	6"	42"	3/4"	\$119.87	N/A
F696	6"	96"	3/4"	\$393.07	N/A



Base End Panel (D.W)

SKU	Width	Height	Depth	CS Price	CA Price
DWEP	23 3/4"	34 1/2"	3/4"	\$141.97	N/A



Valance

SKU	Width	Height	Depth	CS Price	CA Price
VAL36	4 1/2"	36"	3/4"	\$134.61	N/A



Glass Door

SKU	Width	Height	Depth	CS Price	CA Price
GD1230	11 7/8"	29 7/8"	3/4"	\$198.78	\$203.75
GD1530	14 7/8"	29 7/8"	3/4"	\$248.47	\$254.68
GD1830	17 7/8"	29 7/8"	3/4"	\$293.63	\$300.97
GD1236	11 7/8"	35 7/8"	3/4"	\$255.39	\$261.77
GD1536	14 7/8"	35 7/8"	3/4"	\$319.23	\$327.21
GD1836	17 7/8"	35 7/8"	3/4"	\$377.93	\$387.38
GD1242	11 7/8"	41 7/8"	3/4"	\$297.64	\$305.08
GD1542	14 7/8"	41 7/8"	3/4"	\$372.04	\$381.34
GD1842	17 7/8"	41 7/8"	3/4"	\$440.89	\$451.91

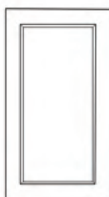

Sample Door

SKU	Width	Height	Depth	CS Price	CA Price
SD12	12"	16"	3/4"	\$71.50	\$73.29

Warranty

Sensi Home LLC. warrants its products to the original consumer purchaser with a LIMITED WARRANTY for ten years from the time of purchase. Should any of our products fail under normal use due to defects in material or workmanship within these ten years, Sensi Home LLC will, at its discretion, repair or replace the defective part. This warranty does not cover products that are damaged due to accidents, misuse, improper handling, improper installation, improper cleaning, or extreme temperature or moisture levels. This warranty does not cover products that have been altered or modified in any way. This warranty is not valid for products used for any purpose other than the purpose for which they were originally intended. This warranty is limited to the replacement or repair of the defective product only and does not include service, labor, or transportation costs, regardless of whether work was performed by a specialist or yourself. Natural variations in color and grain patterns are inherent characteristics of wood. Color changes may occur in the finished wood products as a result of exposure to light and other elements which are part of the aging process. Additionally, a characteristic of wood is that it expands and contracts over time. These material variations and changes are not covered by this warranty

This warranty does not apply to any products used in conjunction with Sensi Home's products, such as countertops, appliances, or plumbing fixtures. Repair or replacement is subject to the present product offering of Sensi Home LLC at that time. No dealer, agent, contractor, or installer may change or extend this warranty. In place of any other warranties, this warranty shall represent the entire liability of Sensi Home LLC. All styles, finishes, and specifications are subject to change without prior notice.

Terms & Conditions

Conditions of Sale: It is the sole responsibility of the client to review the accuracy of orders by way of order confirmation. Orders will not be processed until confirmation is received. Only the confirmed sales order will be recognized as an approved order. Sensi Home holds no responsibility for assembly or installation errors.

Receiving requirements for warehouse pick-up or delivery:

- Step 1: It is the responsibility of the client to inspect all product(s) to verify all items are present and free of visible damage before loading vehicles of products.
- Step 2: Visually check the product for damage. IMPORTANT: If the box appears to be damaged, notify the warehouse manager of the damage.
- Step 3: Check the pick-up list against the actual items and quantity before loading the vehicles. Item numbers are located on the outside of each box.
- Step 4: Customers are responsible for loading their own vehicles.
- Step 5: If something is incorrect or missing, notify the warehouse manager.
- Step 6: Sign the pick-up list.

*ONCE THE PICK-UP LIST IS SIGNED, NO CLAIM CAN BE MADE FOR DAMAGED OR MISSING PRODUCTS. ASSEMBLED PRODUCTS CANNOT BE RETURNED UNDER ANY CIRCUMSTANCE.

Delivery Service: Delivery is available in Dade, Broward, and Palm Beach Counties. Deliveries are curbside only. It is the responsibility of the client to retrieve cabinets directly from the delivery vehicle. It is the responsibility of the client to inspect all products and verify all items are present and free of visible damage before signing for products. If something is wrong or missing, notify the driver. The driver will return to the warehouse and the replacement will be rescheduled for delivery. Sign the delivery list. Concealed damage will not be picked up or delivered.

Returned Goods Policy: Clients must submit the Merchandise Return Form to info@mysensihome.com or in person. No products shall be returned to Sensi Home until a return authorization has been issued. Sensi Home assumes no responsibility for items returned without this authorization. Products must be returned within thirty (30) days of the invoice date. All boxes containing the returned products must be unopened and undamaged. Under no circumstances can assembled products be returned. Customers are responsible for all transportation charges associated with returns, and customers will assume all risks of loss and damage until the products are delivered to the Sensi Home Warehouse. Upon receipt and inspection of the returned products, Sensi Home will issue an account credit for the invoice amount for qualifying returns and will incur a twenty percent (20%) restocking fee. No credit will be issued for lost or damaged items.

Concealed Missing, Damaged, or Defective Parts Policy: Any damaged, missing, or defective parts must go through the following process to be resolved. The client has 15 days from the invoice date to report any concealed damage. Check to make sure all parts are present and free of damage as the product is taken out of the carton. Any missing or damaged parts must be photographed, with close-up and wide-angle photographs of the damage before assembly. Send a request with a detailed description, sales order #, and photos to info@mysensihome.com. No product will be replaced free of charge without sales order # and photos or after the cabinet is assembled. Sensi Home has 2 business days to review the request. Sensi Home will notify the client within this time frame as to the result of the review. If the product(s) are to be replaced at Sensi Home's expense, they will be available for pick-up within 24 hours of notice, current inventory levels of Sensi Home permitting. Sensi Home cannot be held responsible for any cost including labor accrued during the installation of any of its products sold via any channels of distribution. This includes, but is not limited to, products that may be flawed or have been damaged in transit.

DISCLAIMERS: Defects do not include items beyond reasonable control, including but not limited to, the following: Wood and Color Variations. Natural variations in the color, textures, and grain of the wood used to manufacture cabinets or changes in the color of the wood caused by the natural aging process of the wood material are not considered defective. Wood Doors: Changes to wooden doors caused by changes in humidity, temperature, and other local atmospheric conditions are not considered defects. Note also that doors that appear warped may often be the result of improper installation. Painted Finishes: Changes (such as finish stress lines) caused using non-porous woods (such as birch) or by changes in humidity, temperature, and other local atmospheric conditions are not considered defects.

Design Service: Sensi Home provides a design service for your convenience. The fee for this service is \$50 for a limited design (basic layout) and \$100 for a moderate design (3-D render). This fee will be required before service is provided. • Sensi Home holds no responsibility for improper measurements or incorrect cabinet sizes provided by the customer. Designs are not considered orders.

Payment Terms: Sensi Home requires payment of the invoice upon order confirmation.

Quotations of Price: All written quotations of price ("Quote") made by Sensi Home will be valid for thirty (30) days, without exception, from the date of the Quote generated by Sensi Home. Sensi Home will not honor verbal quotations of price.

Taxes: All sales tax, excise taxes, or other forms of taxes levied against this transaction shall be paid by the Buyer over and above all other sums. These taxes are in addition to the purchase price of the products subject to an order. If you are exempt from tax, an original signed tax exemption certificate must be submitted to Sensi Home on an annual basis. Without a valid signed tax exemption certificate on file at Sensi Home, all applicable taxes will be charged to the Buyer.

Governing Law: All issues concerning the formation, performance, or interpretation of any contract regarding this sale shall be governed by the laws of the state of Florida, and any dispute between Sensi Home and Buyer will be resolved in Florida, the prevailing party in that dispute entitled to its costs and reasonable attorney's fees.

Severability of Terms: If any phrase, clause, or provision shall be declared void, the validity of any other provisions shall not be affected there.



SensiHome

Consider it *done!*

Sensi Home LLC
1325 NW 98CT - UNIT 13
DORAL, FL 33172

Tel: (305) 456 0729
Email: info@mysensihome.com
www.mysensihome.com

Follow on social media:
[@mysensihome](https://www.instagram.com/mysensihome)

